



39 Westbourne Avenue, Gateshead, NE8 4NF

£675

Bell Estate Agents welcome to the market this two bedroom ground floor flat, available July, unfurnished. Situated within easy reach of Saltwell Park..

Situated at the top of Westbourne Avenue this generous size ground floor flat is close to local amenities with excellent transport links. The internal accommodation briefly comprises of an L Shape entrance lobby and hallway with storage cupboard leading to two well proportioned bedrooms the largest of which is a large double bedroom. Completing the layout is a contemporary style lounge with original features, a galley style kitchen with integrated appliances and tiled flooring and a three piece family bathroom with shower over bath, WC and pedestal basin.

Externally the property has an enclosed yard space with access out into the rear yard. Viewings are highly recommended

Floor Plan

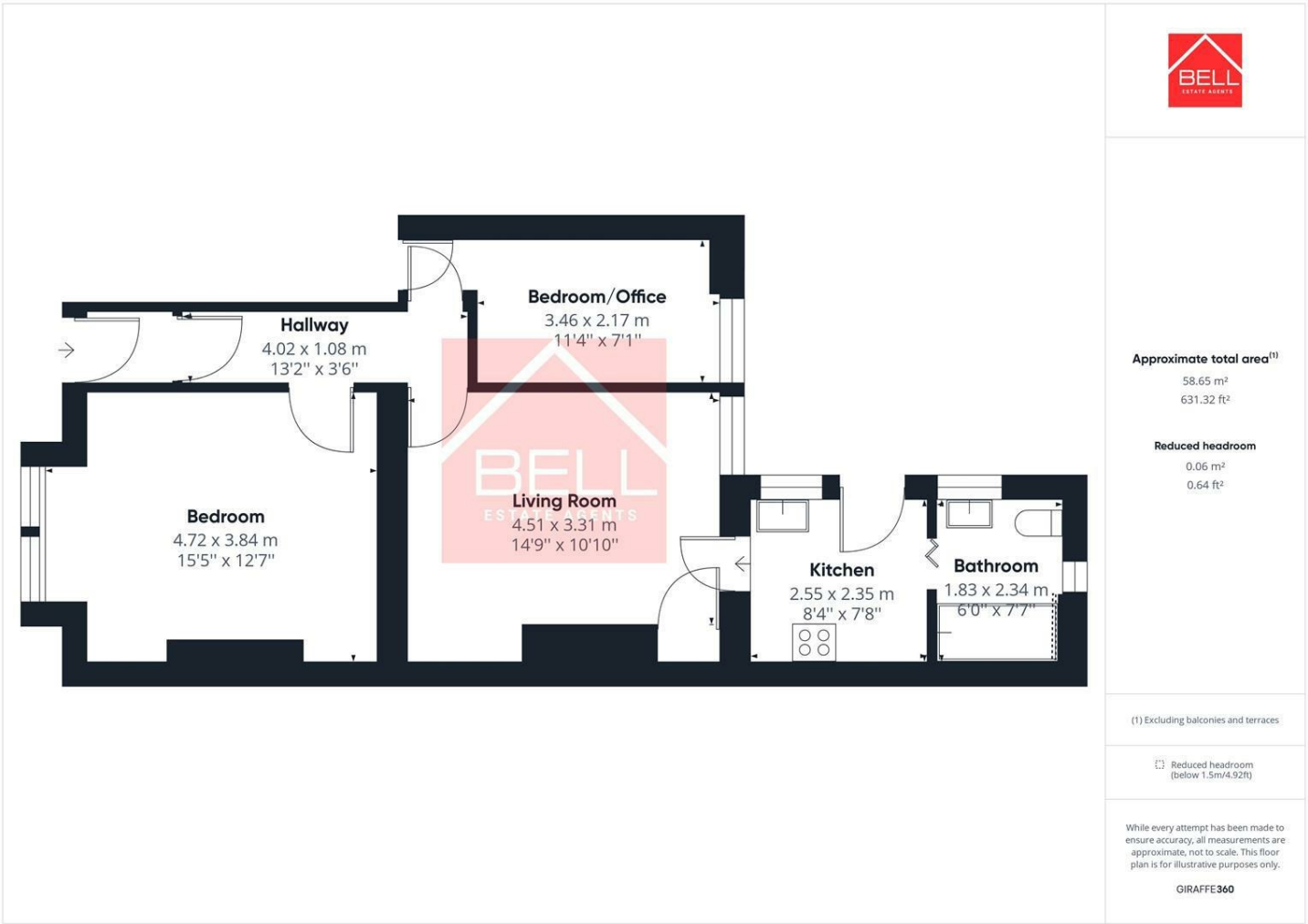

Area Map

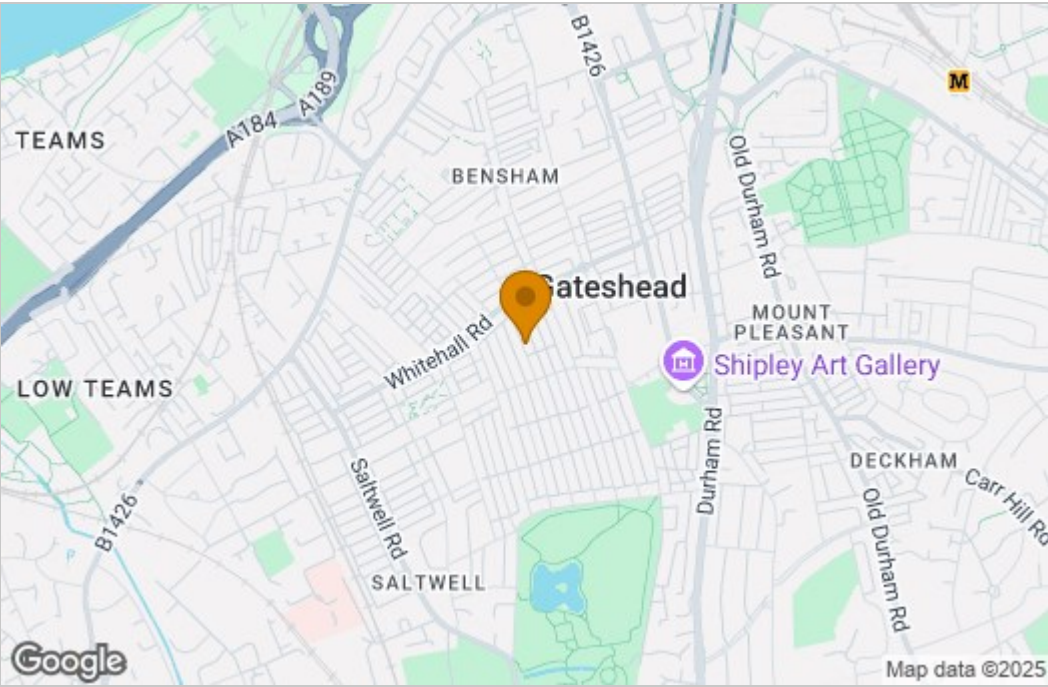

Energy Efficiency Graph

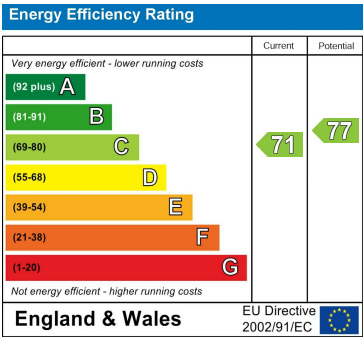

These particulars, whilst believed to be accurate are set out as a general outline only for guidance and do not constitute any part of an offer or contract. Intending purchasers should not rely on them as statements of representation of fact, but must satisfy themselves by inspection or otherwise as to their accuracy. No person in this firms employment has the authority to make or give any representation or warranty in respect of the property.